

Universal/Standard Ku-band Medium Power BUC

Features

High efficiency, high output power
 Low power consumption
 Compact size and lightweight
 Custom engineered available

General information

The Skylink Ku-band compact Block Up Converters are built for high reliability operation. The use of the most advanced semiconductor chip technology and space synthesis improves the efficiency and reduces the size of the unit.

Applications

Satellite communication



Picture just for reference

Options

16/25/40/80W output power optional
 IF 950-1450MHz/950-1700MHz optional
 Monitor & Control option

Electrical specifications

Tested @ T=25Deg.C, R=50

Model	SL-BUC-140G145-25	SL-BUC-140G145-40	SL-BUC-140G145-80
Frequency Range	14-14.5GHz	14-14.5GHz	14-14.5GHz
Psat (Typ.)	44.5dBm	46.5dBm	49.5dBm
P1dB(Typ.)	≧ +44 dBm	≧ +46 dBm	≧ +49 dBm
IF Frequency	950-1450MHz		
External Ref. Power (10MHz)	0dBm+/-10dB		
Max. Input Power	+10dB		
Small Signal Gain	70dB typ.		
Gain Flatness	3dB p-p(500MHz)/1dB p-p(40MHz)		
Gain Variation Over Temp.	≤3dB		
Gain Adjustment	15dB with 1dB step size		
AM/PM	2deg./dB (@ P1dB)		
Third Order Intermod	-25dBc @P1dB back off 3dB		
Input VSWR	2:1		
Harmonic Rejection	≧ 10dBc		
Spurious Rejection	≧ 60dBc		
Phase Noise	-63dBc@100Hz; -73dBc@1KHz; -83dBc@10KHz; -93dBc@100KH		
Noise Figure	15dB		
DC Voltage	+48VDC(35V~75V)		

Universal/Standard Ku-band Medium Power BUC

Power Consumption (Plinear)	185W Typ.	240W Typ.	620W Typ.
Power Consumption (P1dB)	205W Typ.	275W Typ.	675W Typ.

Mechanical Specifications

Model	SL-BUC-140G145-25	SL-BUC-140G145-40	SL-BUC-140G145-80
Dimensions WxDxH	220x137x100mm		TBD
Weight	3.2KG		TBD
RF Input Interface	N female		
RF Output Interface	WR75		
DC Supply	12-Pin military circular connector		
Monitor	RS-485; Ethernet optional		

Environmental Specifications

Parameters	Value
Operating Temp.	-20~+50°C
Storage Temp.	-45~+70°C
Relative Humidity	0-95%

Outline Drawing

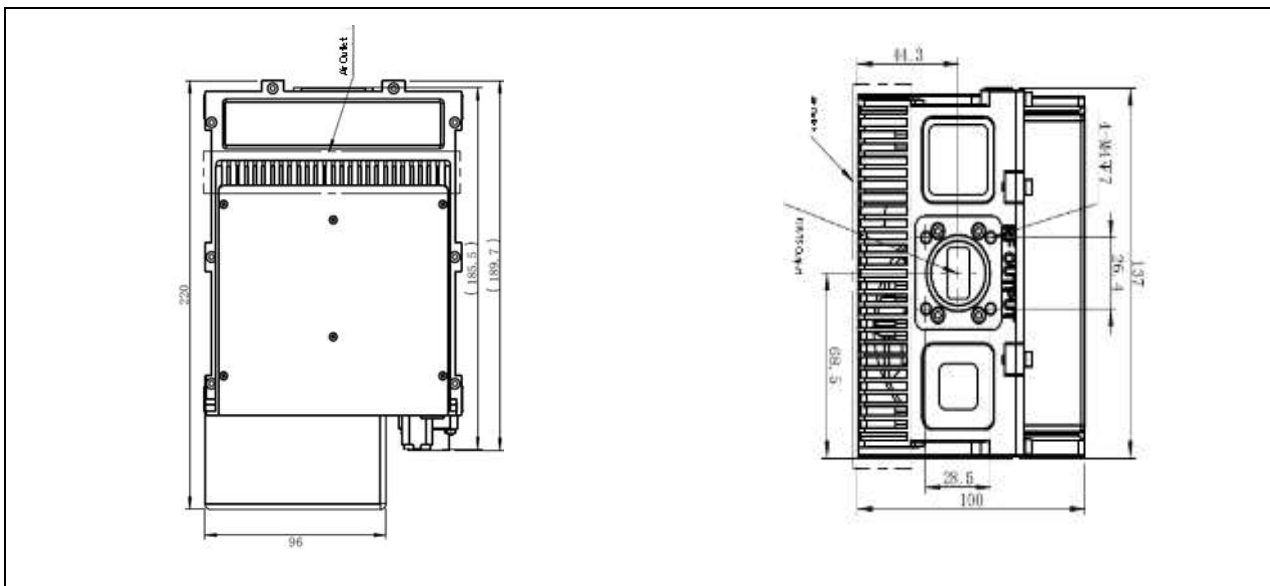

Observation: Outline just for reference, final one might be different upon the functions and customer's requirement.